

Front view and mounting

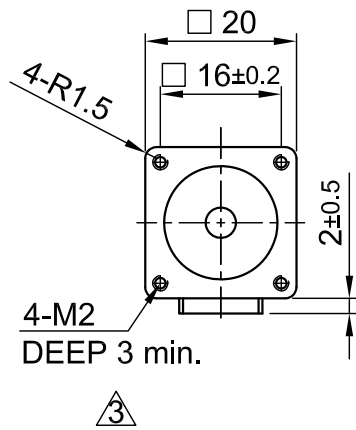

Side view

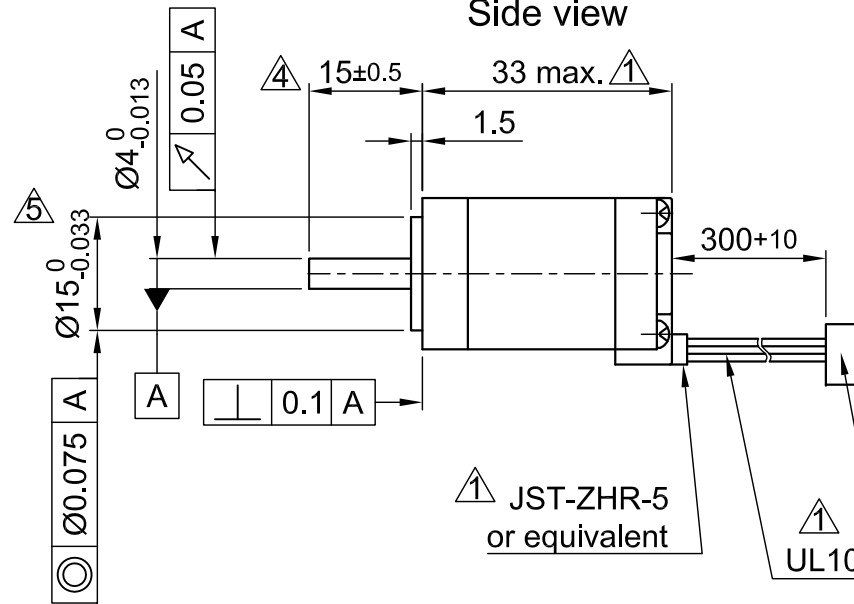

Rear view

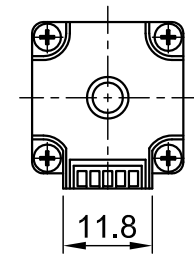

Connector: JST XHP-4
Contact: SXH-001T-P0.6

JST-ZHR-5
or equivalent

UL1061 AWG26

| SPECIFICATION | CONNECTION | BIPOLAR |
|--|------------|--|
| VOLTAGE (VDC) | | 3.9 |
| AMPS/PHASE | | 0.6 |
| RESISTANCE/PHASE (Ohms)@25°C | | 6.5±15% |
| INDUCTANCE/PHASE (mH) @1KHz | | 1.7±20% |
| HOLDING TORQUE (Nm) [lb-in] | | 0.018 [0.159] |
| DETENT TORQUE (Nm) [lb-in] | | 9x10 ⁻⁴ [7.95x10 ⁻³] |
| STEP ANGLE (°) | | 1.8 |
| ACCURACY(NON-ACCUM) | | ±5% |
| ROTOR INERTIA (Kg-m ²) [lb-in ²] | | 2.0x10 ⁻⁷ [6.831x10 ⁻⁴] |
| WEIGHT (Kg) [lb] | | 0.06 [0.132] |

PERMISSIBLE RADIAL+AXIAL FORCE

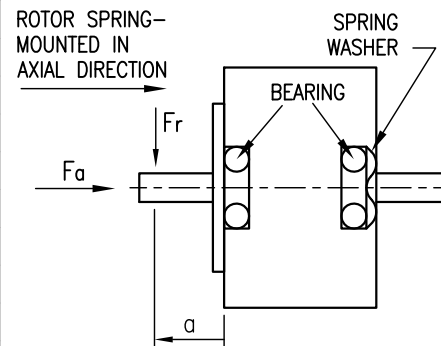

| TYPE OF CONNECTION (EXTERN) | MOTOR | | | |
|-----------------------------|---------|-------------------|-------|---------|
| | BIPOLAR | CONNECTOR PIN NO. | LEADS | WINDING |
| A — | 1 | BLK | A | |
| A\' — | 2 | GRN | A\' | |
| B — | 3 | RED | B | |
| B\' — | 4 | BLU | B\' | |

FULL STEP 2 PHASE-Ex.,
WHEN FACING MOUNTING END (X)

| STEP | A | B | A\' | B\' | CCW | CW |
|------|---|---|-----|-----|-----|----|
| 1 | + | + | - | - | | |
| 2 | - | + | + | - | | |
| 3 | - | - | + | + | | |
| 4 | + | - | - | + | | |

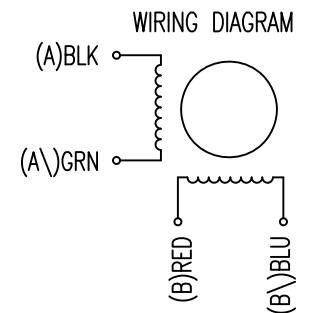

| TEMPERATURE RISE: MAX.80°C (MOTOR STANDSTILL; FOR 2 PHASE ENERGIZED) | AXIAL-FORCE Fa (N) | Fa=4 | | | |
|--|---------------------|-------|----|--------|----|
| AMBIENT TEMPERATURE -10°~ 50°C [14°F ~ 122°F] | DISTANCE a (mm) | 5 | 10 | 15 | 20 |
| INSULATION RESISTANCE 100 MOhm (UNDER NORMAL TEMPERATURE AND HUMIDITY) | RADIAL-FORCE Fr (N) | 30 | 18 | 14 | 8 |
| INSULATION CLASS B 130° [266°F] | | AXIAL | | RADIAL | |
| DIELECTRIC STRENGTH 500VAC FOR 1 MIN. (BETWEEN THE MOTOR COILS AND THE MOTOR CASE) | SHAFT PLAY (mm) | 0.075 | | 0.025 | |
| AMBIENT HUMIDITY MAX. 85% (NO CONDENSATION) | AT LOAD MAX: (N) | 10 | | 5.0 | |

| REV | DESCRIPTION | DATE | DRN | PLUG & DRIVE | | | APVD | S.K. | 02.06.06 | STEPPING MOTOR | |
|-----|----------------------------------|----------|------|-----------------------|--------------------|-----------------|-----------|------|----------|-----------------------|---------------|
| 5 | CHANGE TOLERANCE Ø15/REWORK DRAW | 24.02.16 | A.S. | Surface specification | General tolerances | Work piece edge | CHKD | | | DWG.NO | ST2018S0604-A |
| 4 | CHANGE TOLERANCE+DEL. BACK-EMF | 06.12.13 | J.D. | DIN ISO 1302 | DIN ISO 2768- cH | DIN ISO 13715 | DRN | J.W. | 02.06.06 | | |
| 3 | M2 DEPTH | 11.10.12 | A.S. | | | | SIGNATURE | | DATE | | |