

Front view and mounting

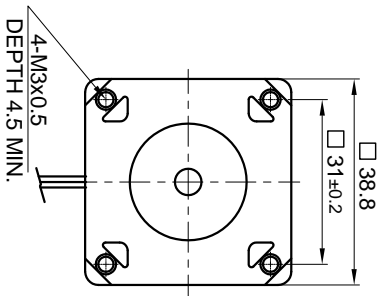

Side view

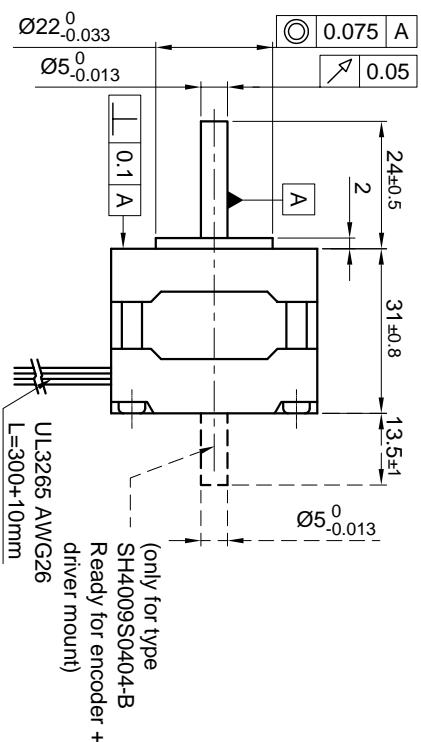

Rear view

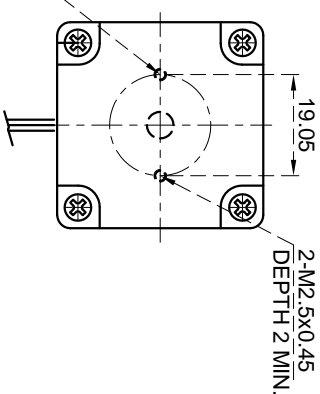

SPECIFICATION	CONNECTION	BIPOLAR
VOLTAGE (VDC)		5.4
AMPS/PHASE		0.42
RESISTANCE/PHASE (Ohms)@25°C		13±15%
INDUCTANCE/PHASE (mH) @1KHz		6±20%
HOLDING TORQUE (Nm) [lb-in]		0.076 [0.673]
DETTENT TORQUE (Nm) [lb-in]		5.4x10 <sup>-3</sup> [0.048]
STEP ANGLE (°)		0.9
STEP ACCURACY (NON-ACCUM)		±5%
ROTOR INERTIA (kg-m <sup>2</sup> ) [lb-in <sup>2</sup> ]		1.7x10 <sup>-6</sup> [5.807x10 <sup>-3</sup> ]
WEIGHT (kg) [lb]		0.17 [0.375]
TEMPERATURE RISE: MAX.80°C (MOTOR STANDSTILL; FOR 2 PHASE ENERGIZED)		
AMBIENT TEMPERATURE -10°~ 50°C [14°F ~ 122°F]		
INSULATION RESISTANCE 100 Mohm (UNDER NORMAL TEMPERATURE AND HUMIDITY)		
INSULATION CLASS B 130° [266°F]		
DIELECTRIC STRENGTH 500VAC FOR 1 MIN. (BETWEEN THE MOTOR COILS AND THE MOTOR CASE)		
AMBIENT HUMIDITY MAX. 85% (NO CONDENSATION)		

PERMISSIBLE RADIAL+AXIAL FORCE

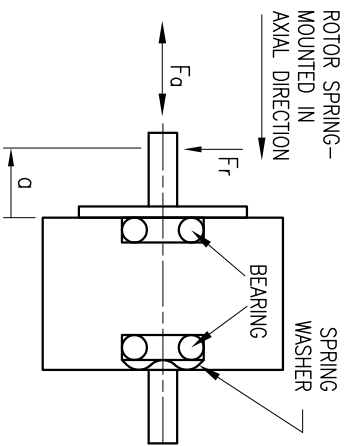

AXIAL-FORCE Fa (N)	Fr=7
DISTANCE a (mm)	5 10 15 20
RADIAL-FORCE Fr (N)	58 36 26 20
AXIAL	0.075
RADIAL	0.025
SHAFT PLAY (mm)	0.075
AT LOAD MAX: (N)	10
	5.0

TYPE OF CONNECTION (EXTERN)	MOTOR
BIPOLAR	LEADS: BLU, RED, WHT, YEL WINDING: A, A\, B, B\

FULL STEP 2 PHASE-Ex, WHEN FACING MOUNTING END (X)

STEP	A	B	A\	B\	CCW	CW
1	+	+	-	-	↑	↓
2	-	-	+	+	↓	↑
3	+	-	-	+	↑	↓
4	-	+	+	-	↓	↑

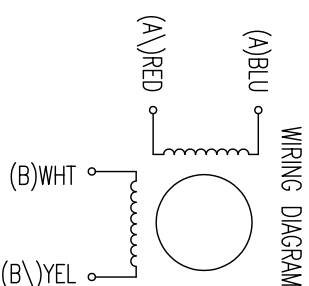

REV	DESCRIPTION	DATE	APVD

NANOTEC:

SH4009S0404

SCALE	FREE	APVD	CHKD	DRN	SIGNATURE	DATE
X	±0.5					
1PL	±0.2					
2PL	±0.1					
ANGLE	±30°					

STEPPING MOTOR

DWG.NO SH4009S0404