

## Permanent magnet stepper motor linear actuator LP2515-LP3575

Via the threaded bush integrated into the motor, the rotational movement can be converted to a linear movement without a complex construction. This compact construction therefore allows space and weight-saving linear adjustment which the LP. provides at very low cost in terms of force and speed.

**Note:** The LP. motors are supplied including spindle.

LPV2515S0104



Pin configuration

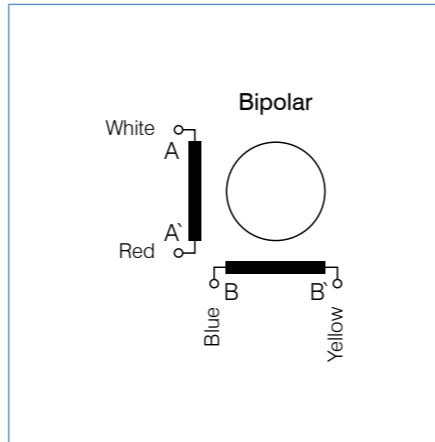

Available versions (others on request)									
Type	Thrust N	Resolution mm/step	Spindle Pitch mm	Travel distance mm	Current A/winding	Resistance per winding Ohm/winding	Step angle	Weight kg	Length "A" mm
-----Data in full step-----									
LPVD2515S0104-TR3.5	5	0.0417	1.00	12	0.10	53	15.0	0.036	15.8
LP2515S0104-TR3.5X1	5	0.0417	1.00	40	0.10	53	15.0	0.036	16.5
LP3575S0504-TR3.5X1.22	55	0.0254	1.22	75	0.46	11	7.5	0.086	17.5

All data refer to 1 half of the winding or unipolar!

LPV2515S0104 outline drawing (in mm)

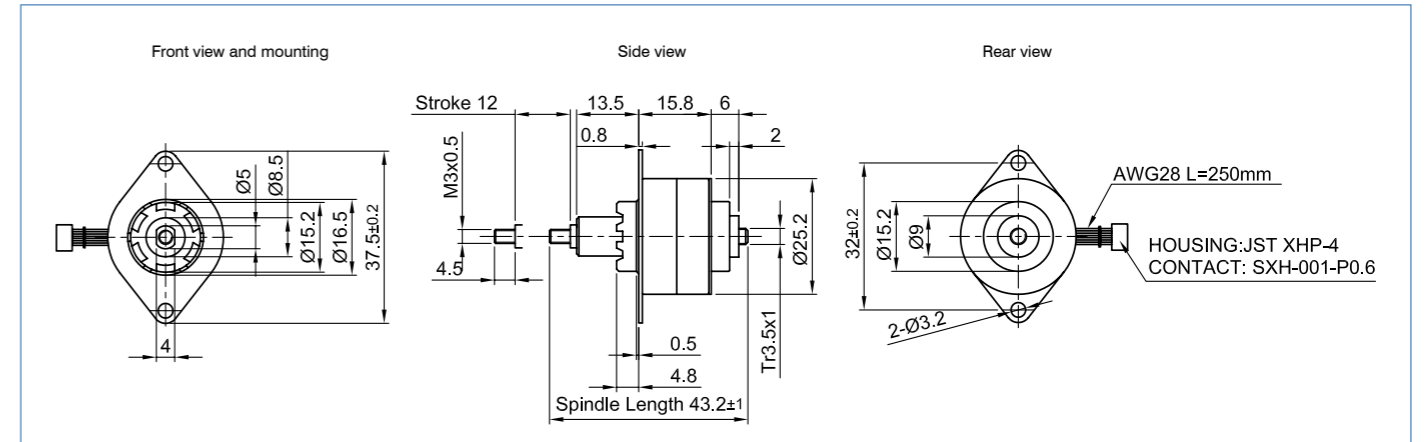

LP2515S0104



Pin configuration

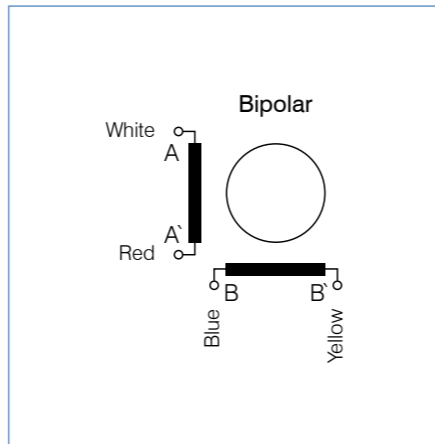

LP2515S0104 outline drawing (in mm)

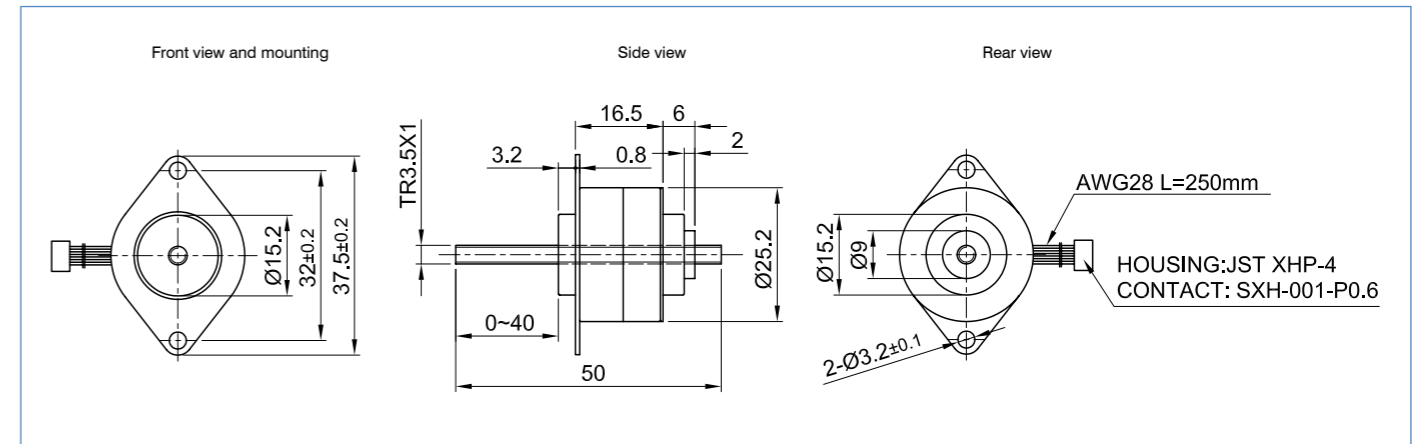

LP3575S0504



Pin configuration

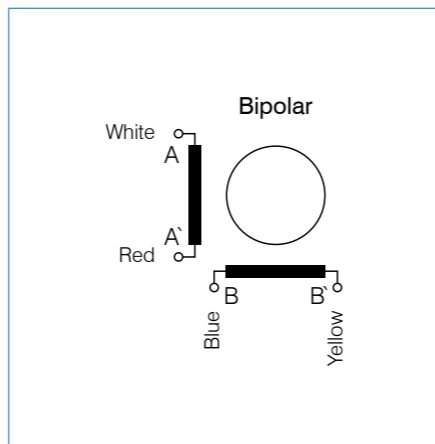

Outline drawing LP3575S0504 (in mm)

