

Type ST6318 - ultraflat stepper motor

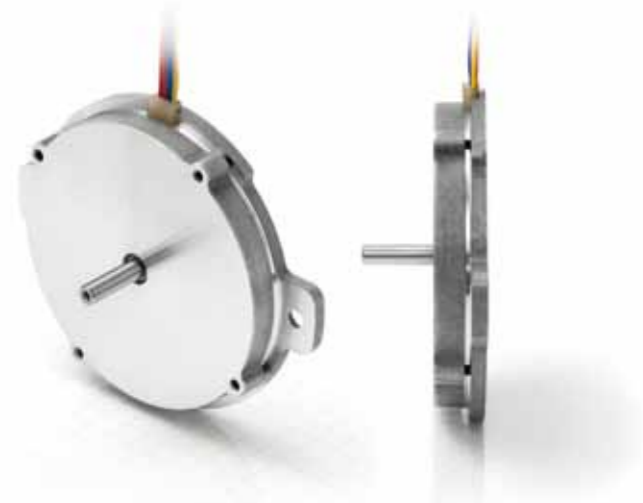

Option



Pin configuration

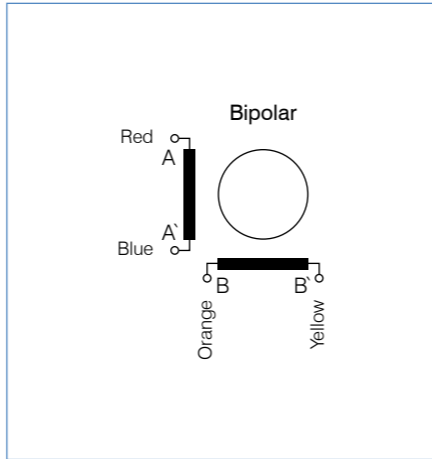

Order identifier

ST 6318 F 1004 - A

The ST6318F1004 ultraflat high-torque stepper motor with a step angle of 1.8° (with microstep up to < 0.02°) supports all engineers in obtaining maximum torque, as well as high positioning accuracy, with a minimal overall height. Thanks to the high torque, a stable speed response is possible at both minimal speeds and at high speeds. The benefits in use arise primarily in applications such as component feeding (feeder), in semi-conductor automation, medical lab and inspection equipment, laser technology, test equipment construction, monitoring cameras, etc. Custom designs are available.

Outline drawing (in mm)

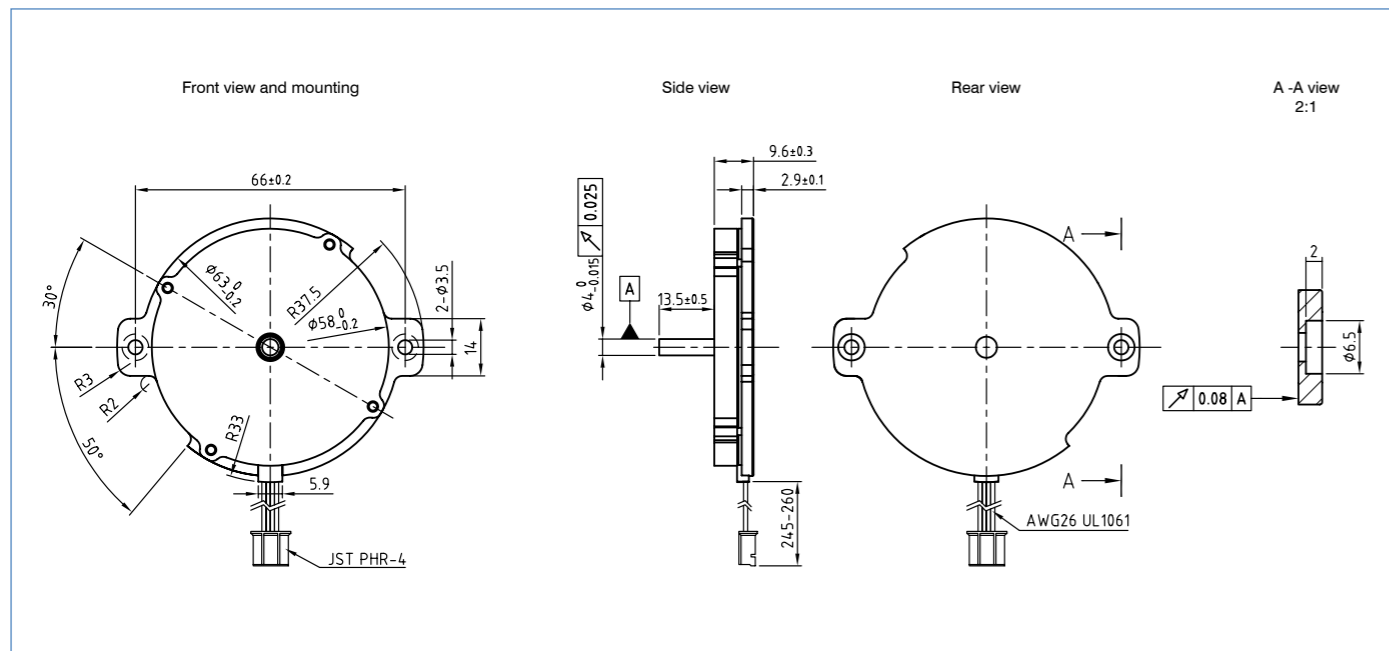

Available versions (others on request)

Type	Current per winding A/winding	Holding torque Ncm	Resistance per winding Ohm/winding	Inductance per winding mH/winding	Rotor inertia torque g cm ²	Weight kg	Length "A" mm
ST6318F1004	1.0	6.0	3.8	2.0	16	0.095	9.5

Speed/torque curves

ST6318F1004

